



## FITTING INSTRUCTION

### TOYOTA REVO

## Note :

Apply WD40 or grease to the moving parts regularly for good performance of the product.

Patent Pending Worldwide

### Part list

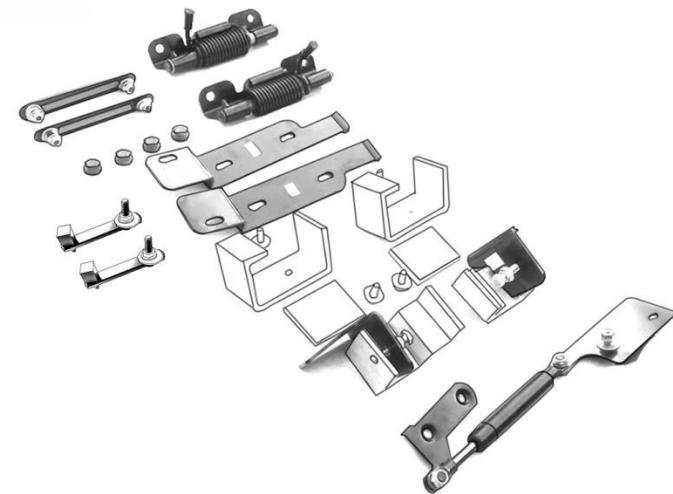

### Tooling



No.12

No.10

No.12

Patent Pending Worldwide



1. Take off tailgate cover plate

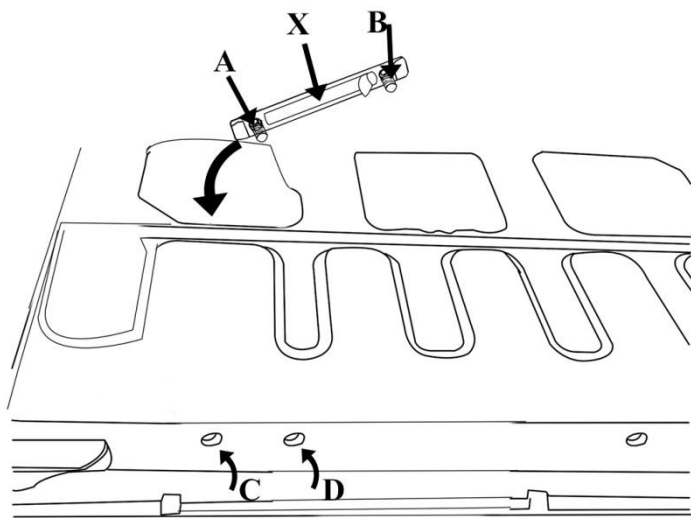

2. put bracket X into the tailgate (peel off glue tape and stick it inside the tailgate). Place bolt A&B through hole C&D

**CAUTION**

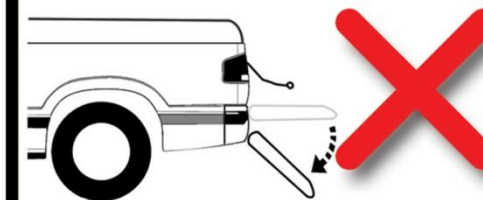

Do not take off  
tailgate cable  
and drop down  
the tailgate

### 11. Install damper bracket (with tailgate)

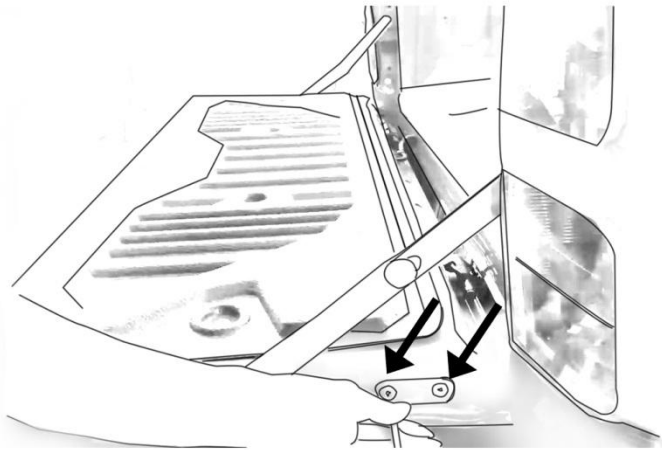

take off original bolts

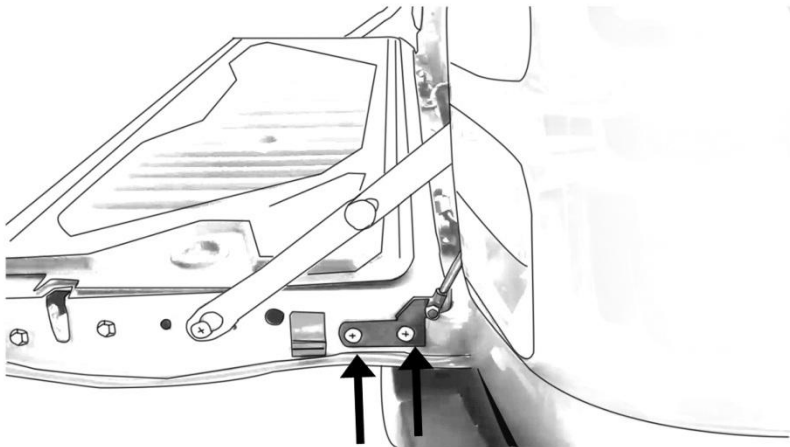

put damper bracket and tighten back the original bolt.

Process #3 - #5 is done while tailgate in close position.

### 3. Put ProLift bracket with tailgate (from the bottom)

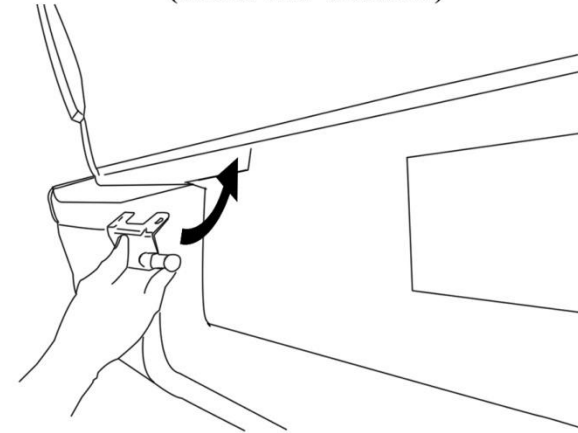

### 4. Tighten nut E&F

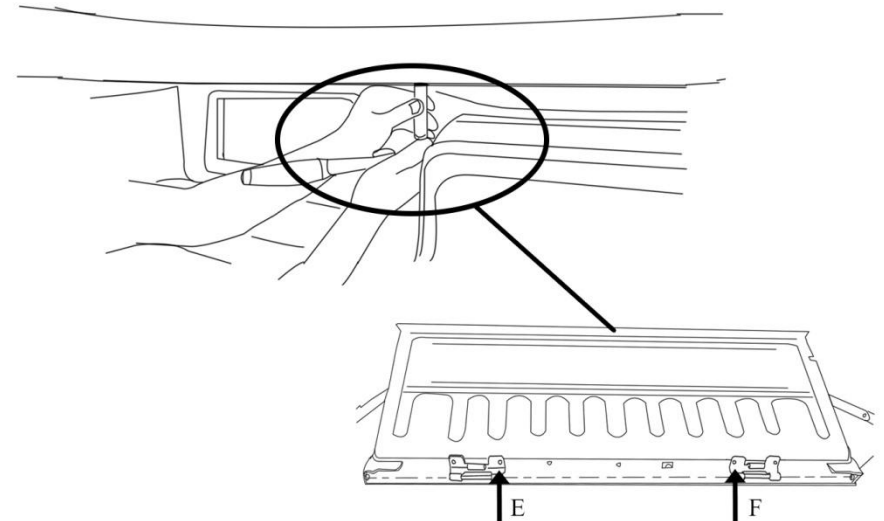

## Install spring leaning bracket

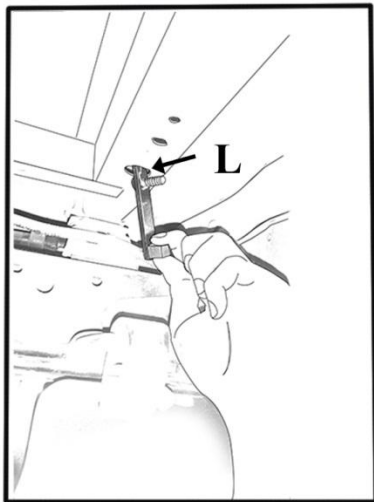
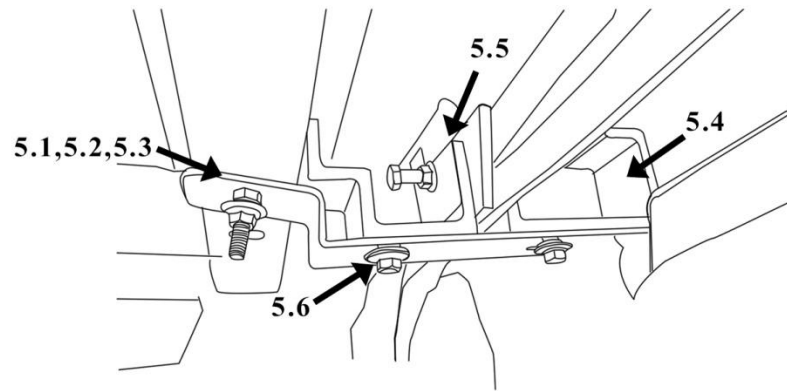

**5.1 put bolt-welded bracket (L) to the position.**

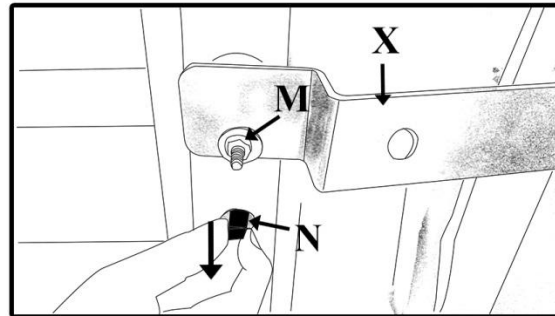

**5.2 put main bracket (X) in position.  
Finger tighten nut M**

## 10. Install damper bracket

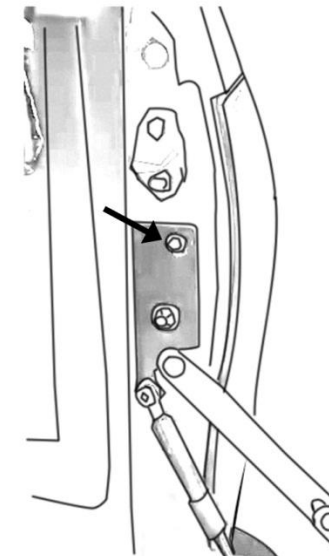
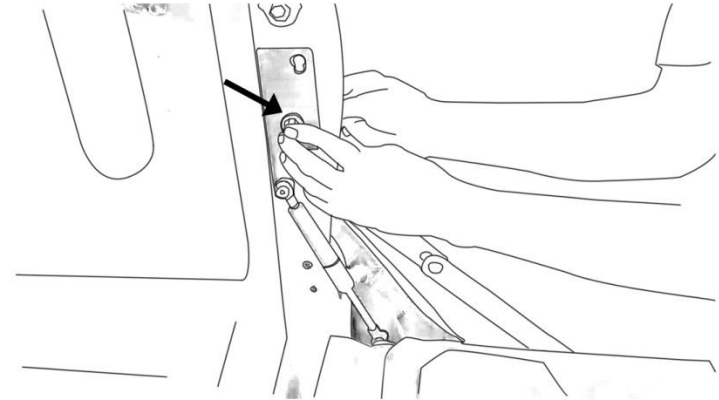

**9. Take off rubber bumper and cut as picture below  
and put it back**

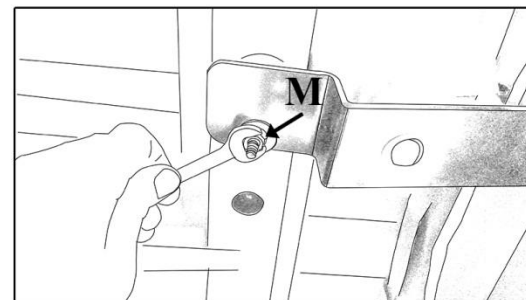
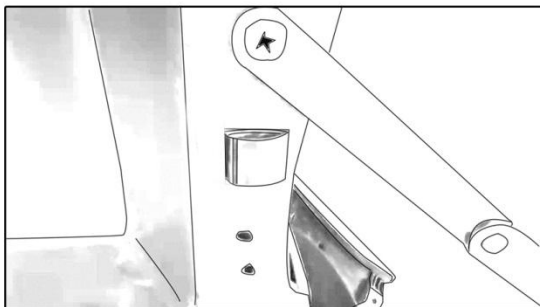
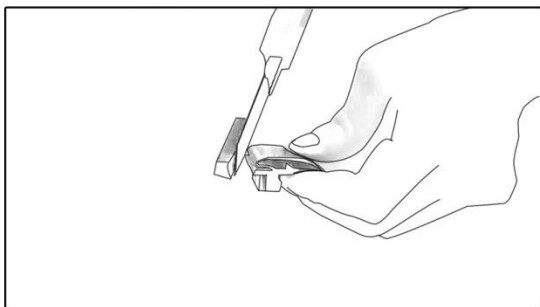
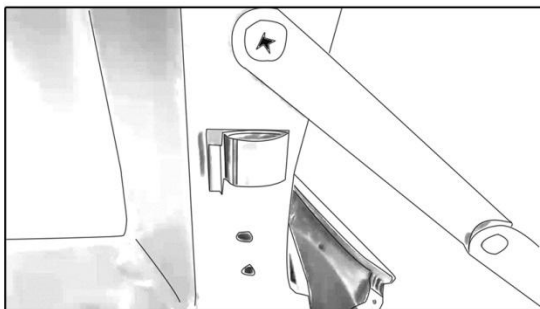

**5.3 tighten nut (M)**

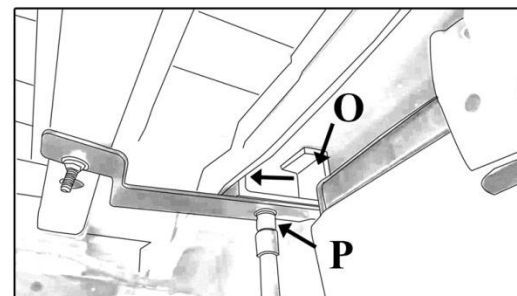

**5.4 put aluminium part (O)  
in place  
and tighten bolt (P)**

**5.5 put bracket (Q) in place  
and tighten bolt (R)**

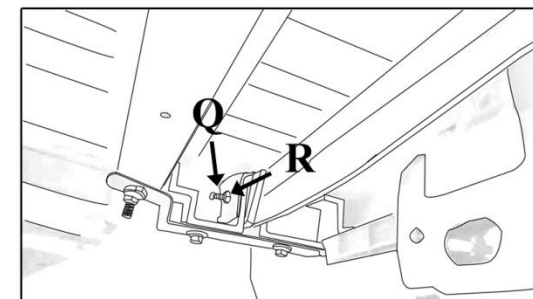

**5.6 tighten bolt (S)**

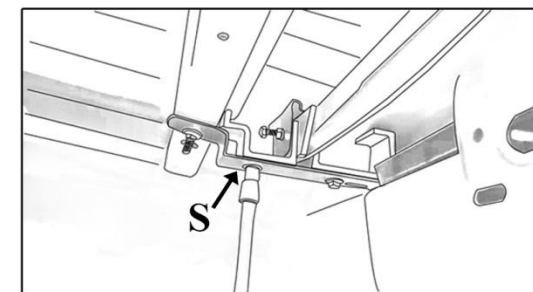

### 6. Tighten nut G&H

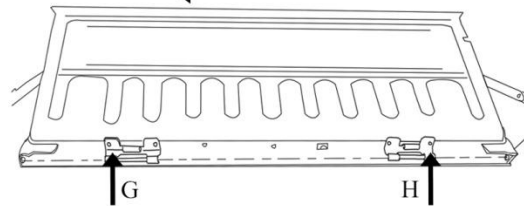
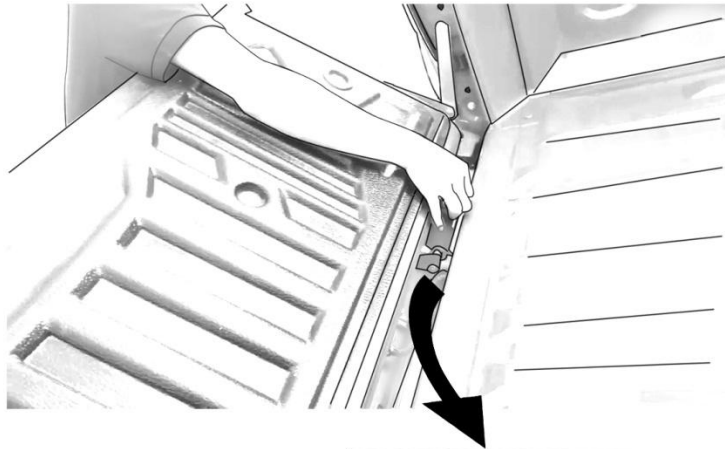

### 7. Put plastic plugs cover nuts

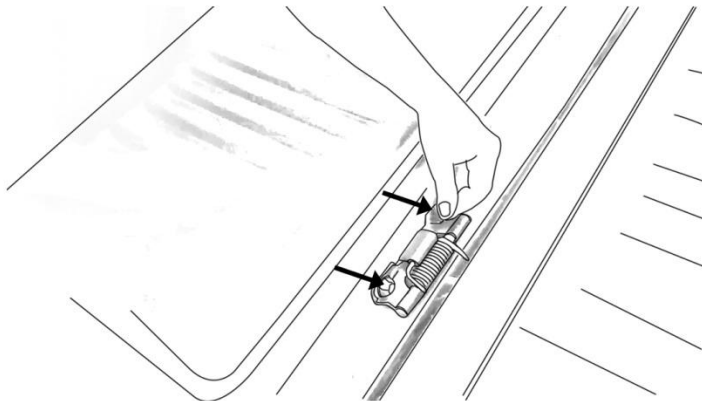

## Install damper

### 8. Unbolt I&J

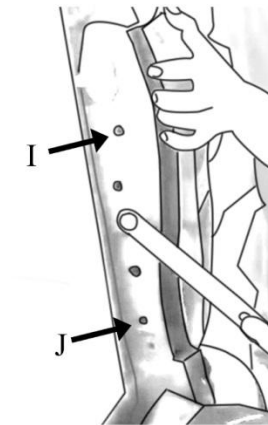

Unbolt I&J

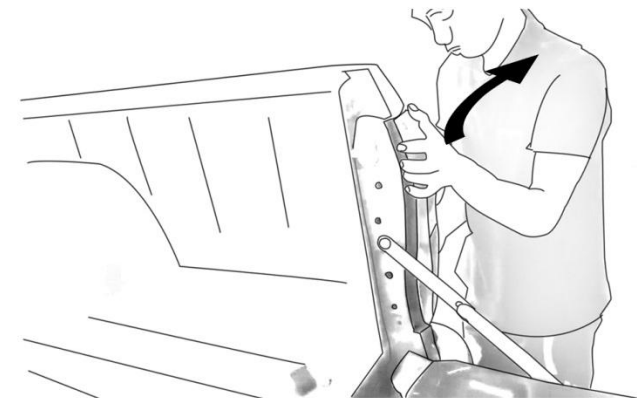

Take out rear light cover  
(direction to the side of the truck)